

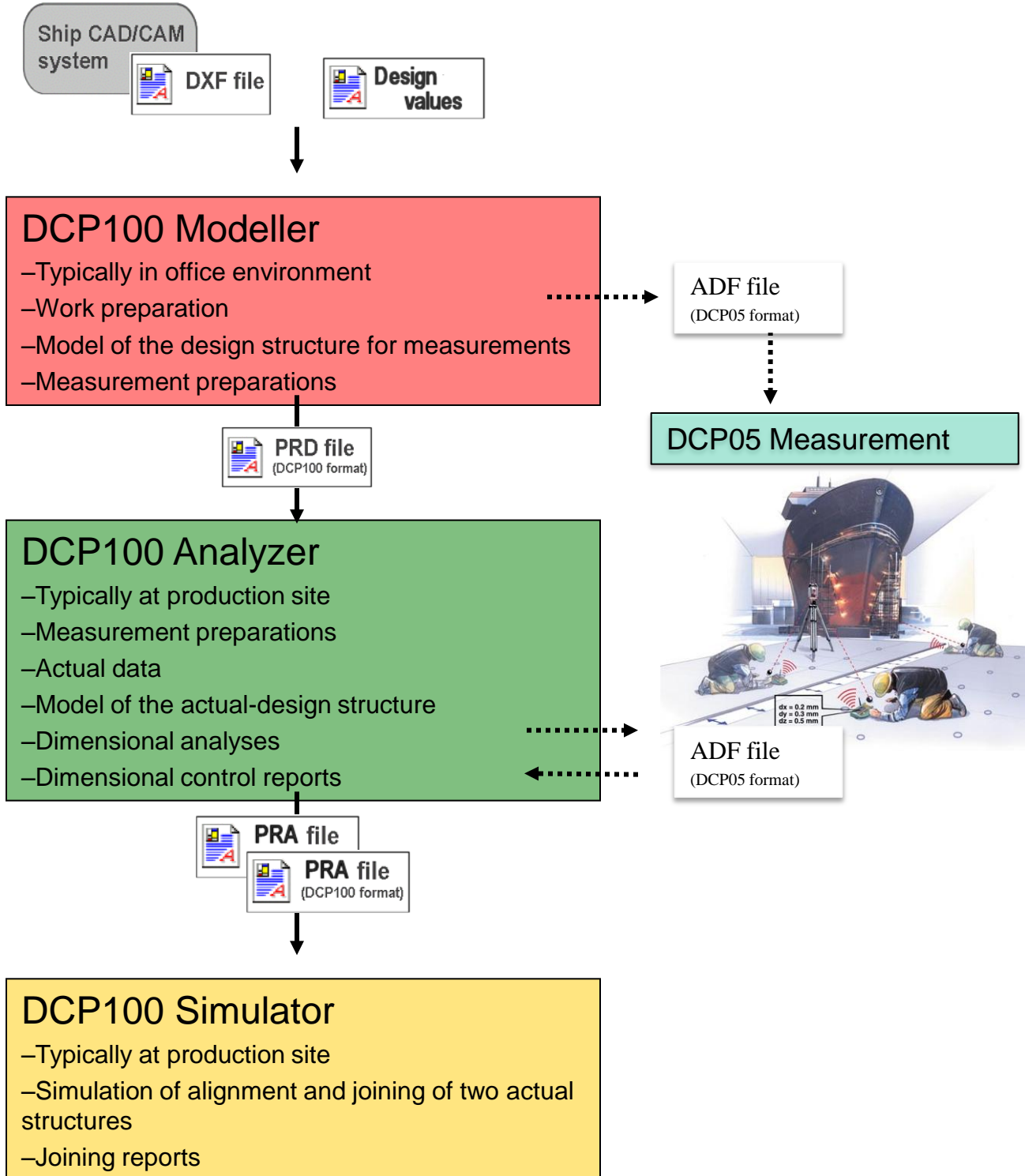

# Work Flow Chart





# Modeller

Ship CAD/CAM  
system



## DCP100 Modeller

- Importation of a dxf-file: automatic generation of the points to be measured
- User can select the amount of details to be imported
- Possibility to manually edit the model
- Creation of measurement form and .adf file for instrument

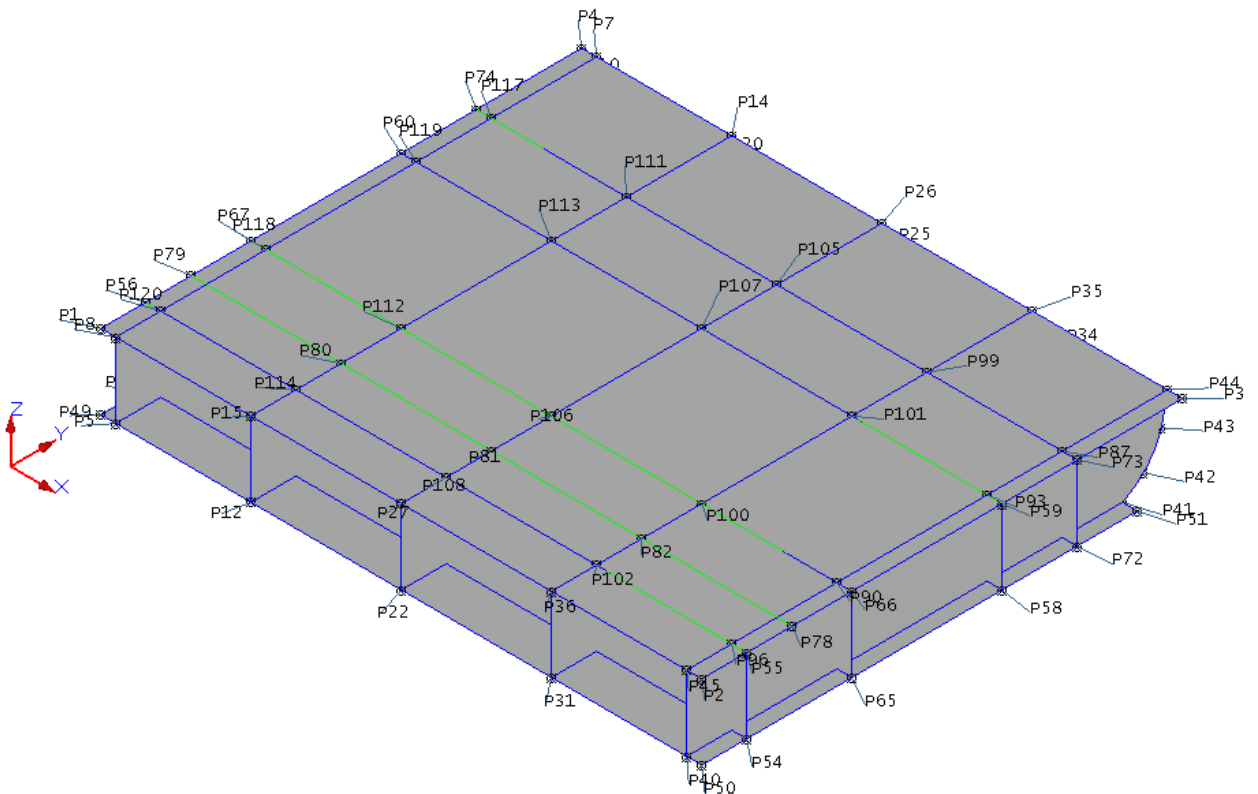



# From Modeller

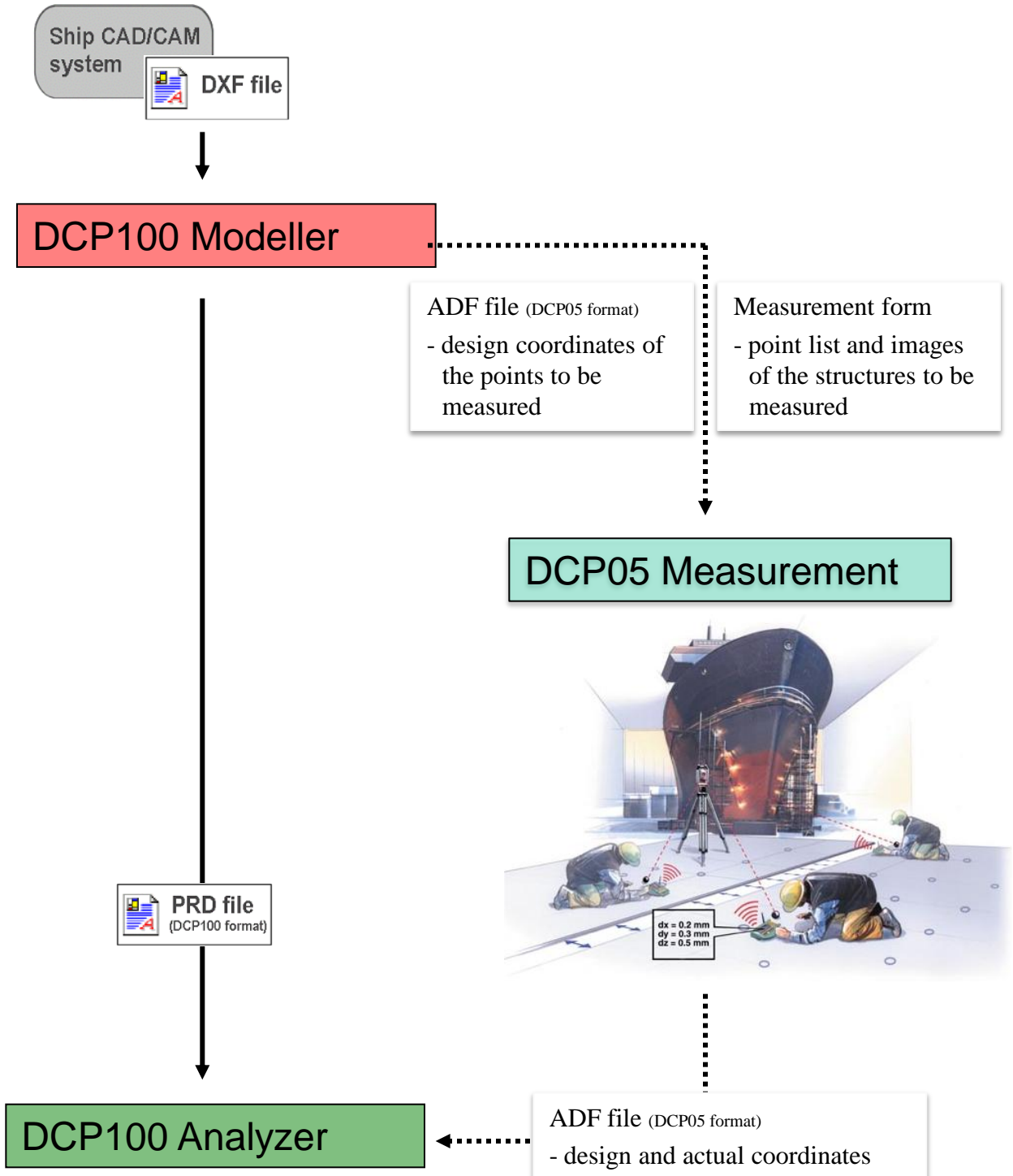



# Measurement

ADF file (DCP05 format)

- design coordinates of the points to be measured

Measurement form

- point list and images of the structures to be measured

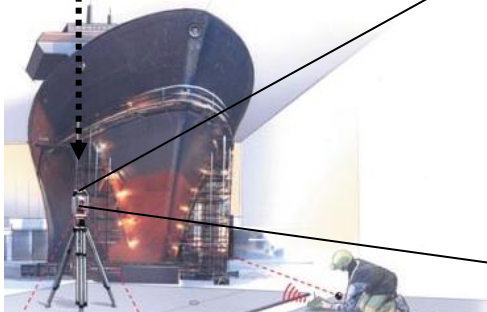

| DCP05\3DMEAS       |         |         |      | 14:03 |  |
|--------------------|---------|---------|------|-------|--|
| 3Drila(3DP) :FILE1 |         | info    |      |       |  |
| Point ID(PID):P1   |         | area    |      |       |  |
|                    | actual  | design  | dev  |       |  |
| x:                 | -1530.2 | -1530.0 | -0.2 |       |  |
| y:                 | 12035.4 | 12035.0 | 0.4  |       |  |
| z:                 | 2580.0  | 2580.0  | 0.0  |       |  |

|      |      |       |      |      |       |
|------|------|-------|------|------|-------|
| ALL  | DIST | POINT | AIM  | PID  | EDIT  |
| HELP | INIT | SPECI | TOOL | CALC | I<>II |
| F1   | F2   | F3    | F4   | F5   | F6    |

## DCP05 Measurement

- actual-design values and deviations can be seen on instrument display in real time
- instrument can also be controlled by using the design values

ADF file (DCP05 format)

- design and actual coordinates



# Analyzer

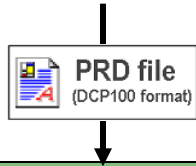

- ### DCP100 Analyzer
- Design values are imported from .prd file
  - Actual values are imported from .adf file
  - Actual-design analysis
  - Alignment functionalities
  - Dimensional control reports with few mouse clicks
    - user can create and use his own report templates
  - New measurements can be prepared
  - Design and actual models are saved into a .pra file

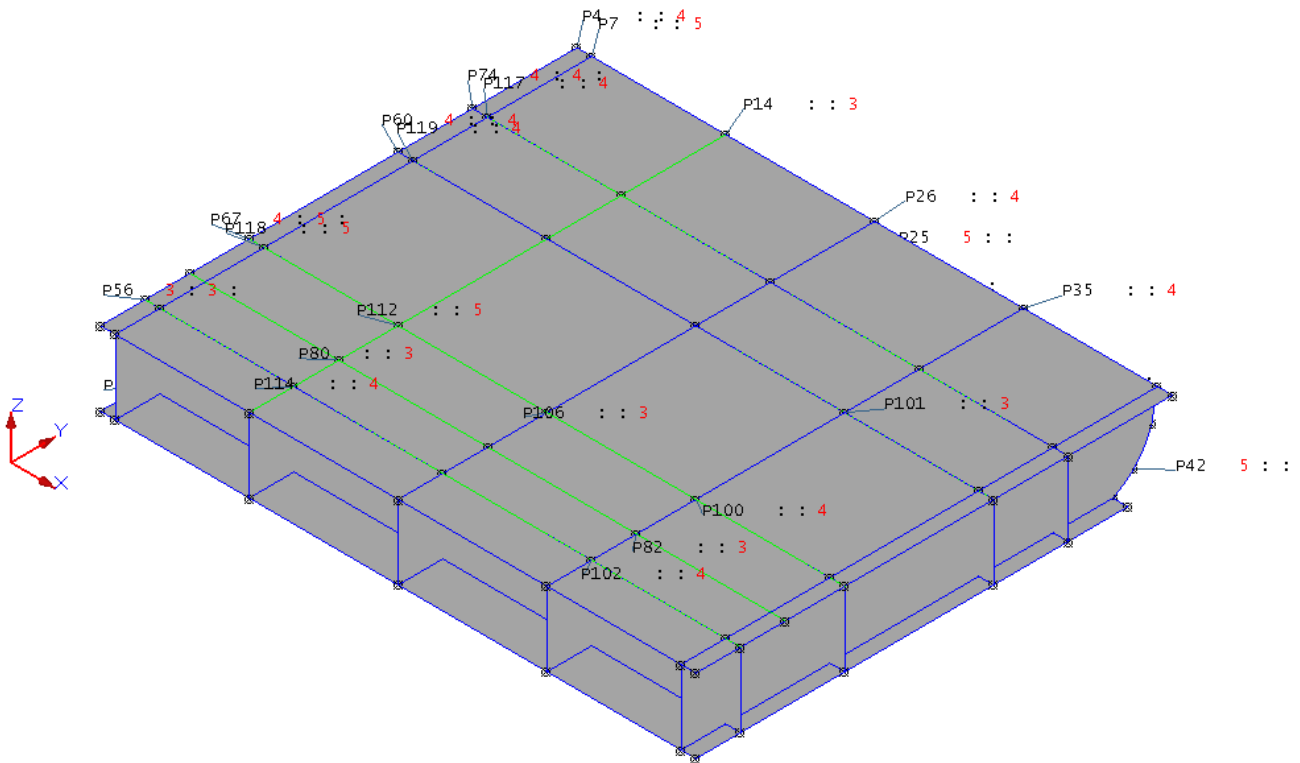



# From Analyzer

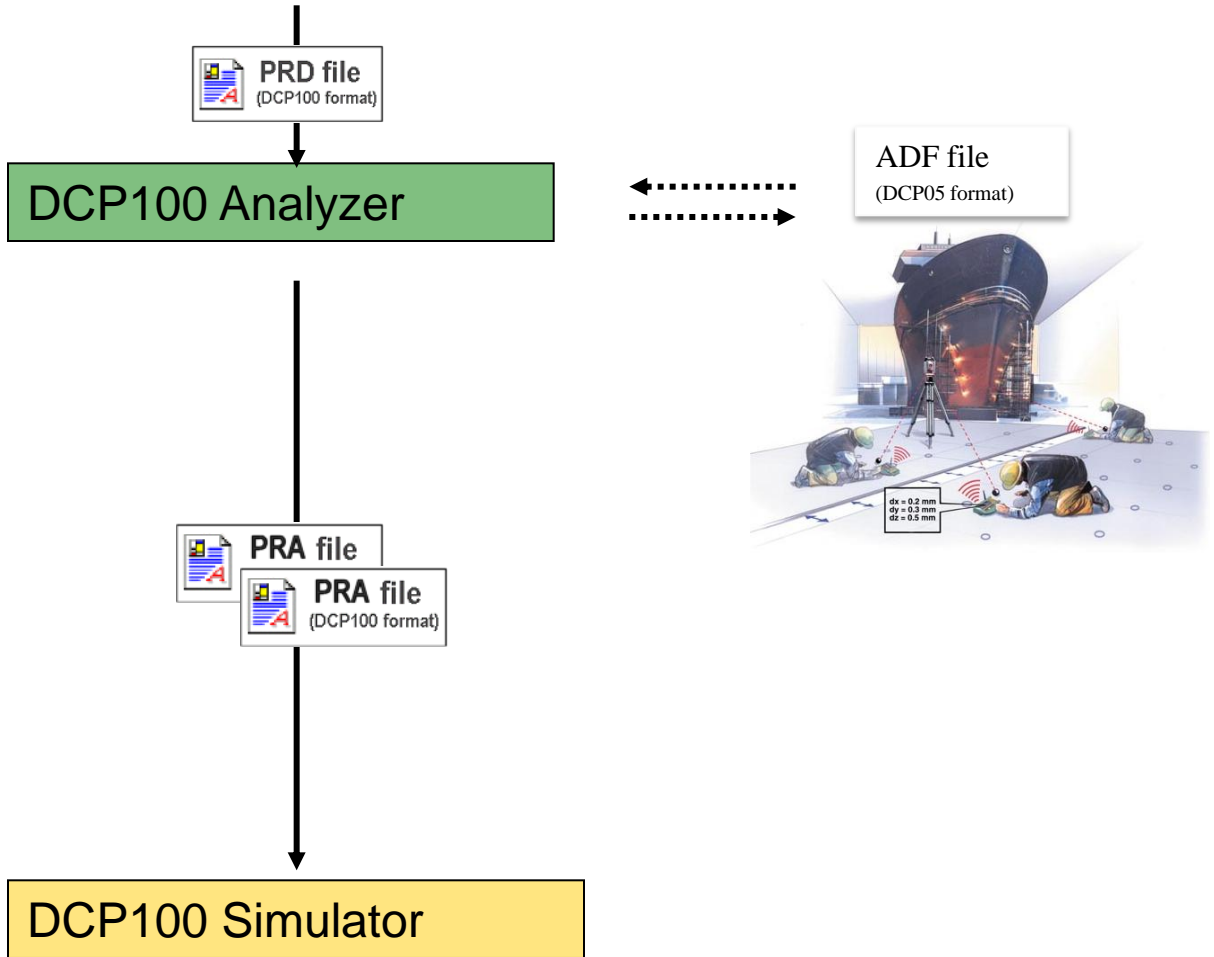



# Simulator

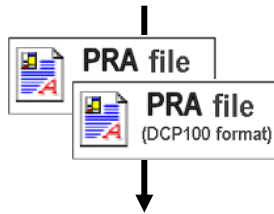

## DCP100 Simulator

- Design and actual models are imported from .pra files
- Simulation of alignment and joining of two actual structures
- Weld gap and Cut map displays to evaluate the success of the unit merging
- Joining reports with few mouse clicks
  - user can create and use his own report template

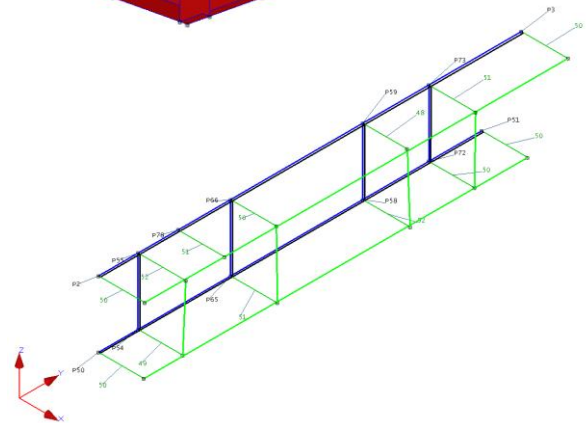
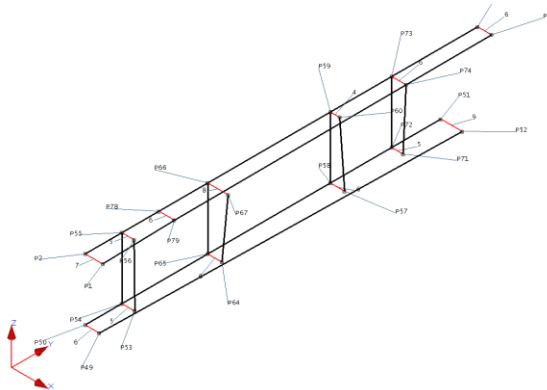
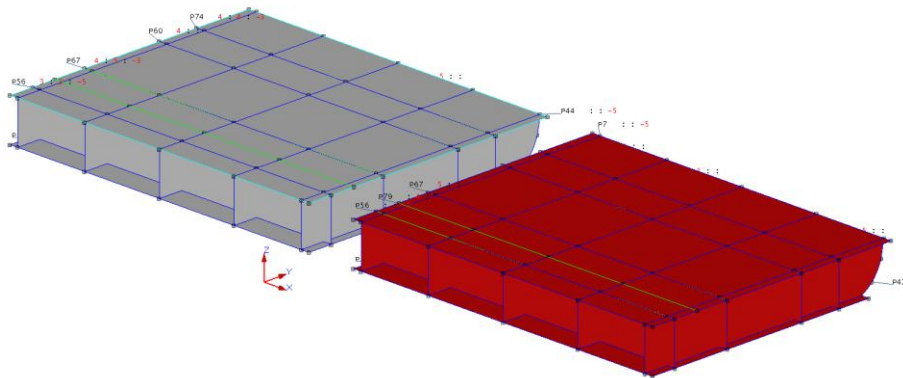

| No. | Points |         | Design coordinates |        |      | Cut away | Weld gap |
|-----|--------|---------|--------------------|--------|------|----------|----------|
|     | Pid    | X       | Y                  | Z      |      |          |          |
| 1   | P2     | 40000.0 | 3.0                | 2500.0 | 50.3 | 7.1      |          |
| 2   | P3     | 40000.0 | 16003.0            | 2500.0 | 50.2 | 5.7      |          |
| 3   | P50    | 40000.0 | 3.0                | 0.0    | 49.9 | 5.8      |          |
| 4   | P51    | 40000.0 | 14503.0            | 0.0    | 50.0 | 8.7      |          |